

Installation Instructions

Network 16 Master Panel Exchange

Step 6

Connect battery.
Recommended battery:
2 x Yuasa NP12-12

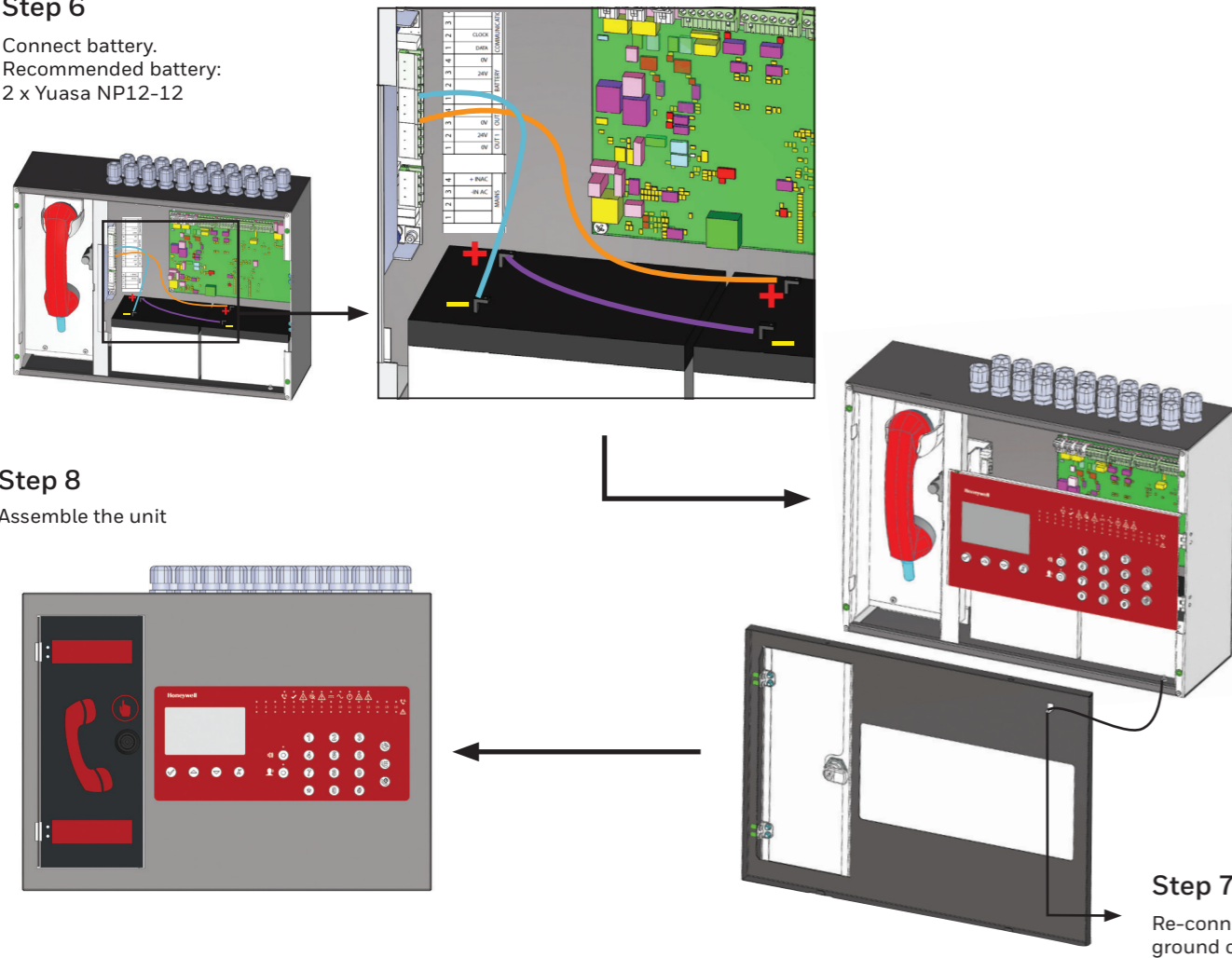

Step 8

Assemble the unit

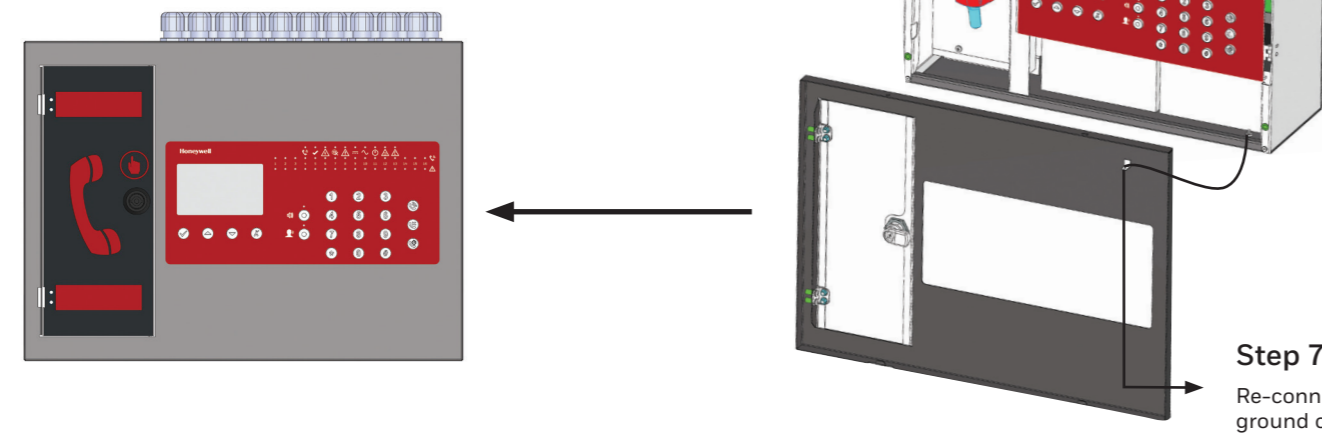

Step 7
Re-connect
ground cable

Flush mount process

Step 1

Re-connect
ground cable

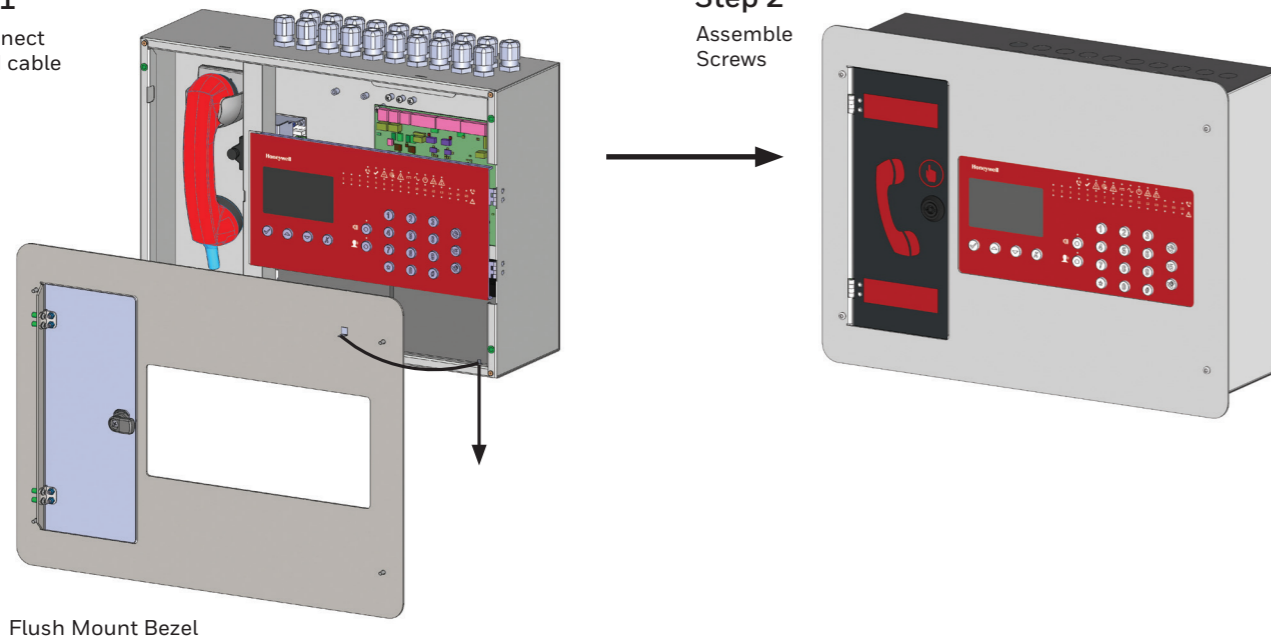

Step 2
Assemble
Screws

Flush Mount Bezel



Product Number	Description
EVCS-MPX-16	Network 16 Master Panel Exchange
MX16-SSC	Master Panel Stainless Steel Flush Cover

Finish & Mounting	Gray; Surface, Flush (Stainless Steel)
Cabling	Enhanced FP200 2x2 / 4X1 Core; 1.5 sq mm
Configuration & Distance	Loop Configuration; Maximum distance between two panels- 300 m Maximum distance between two OS - 200 m Maximum distance between panel and OS – 200 m
Dimension	W 488 x H 355 x D 155 mm (Wall – mount) W 522 x H 390 mm (Bezel)
Weight	6.7 Kg – excluding battery
Knockouts	20 x 20 mm dia at top W 114 x H 37 mm at rear

Honeywell

Honeywell
140 Waterside Road,
Hamilton Industrial Park,
Leicester,
LE5 1TN
Tel: +44(0)203 4091779
Made in Romania

© 2018 Honeywell
All Rights Reserved
Publication No. 25-13899-D
October 2018

Honeywell

Step 1

Open screws to remove top cover.
Lift up the cover. Push back to open. Disconnect ground cable.

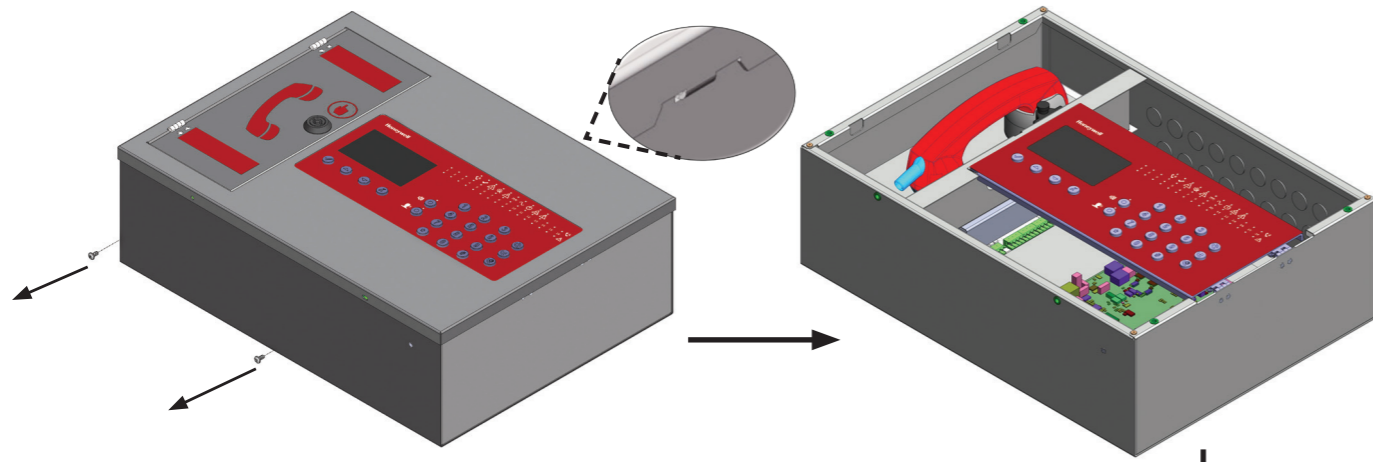

Step 3

Wall Mounting
(User interface has been removed in following images for clarity of instructions. Do not detach the unit)

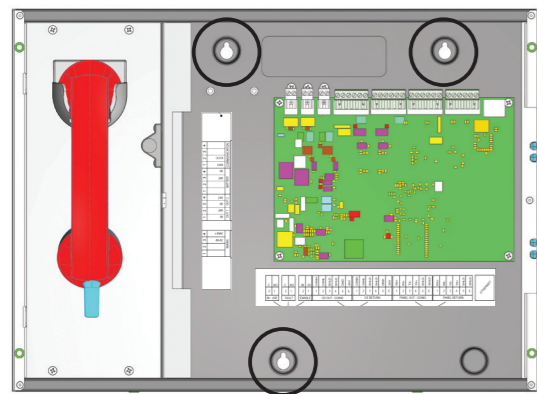

Step 4

Remove Knockouts as required

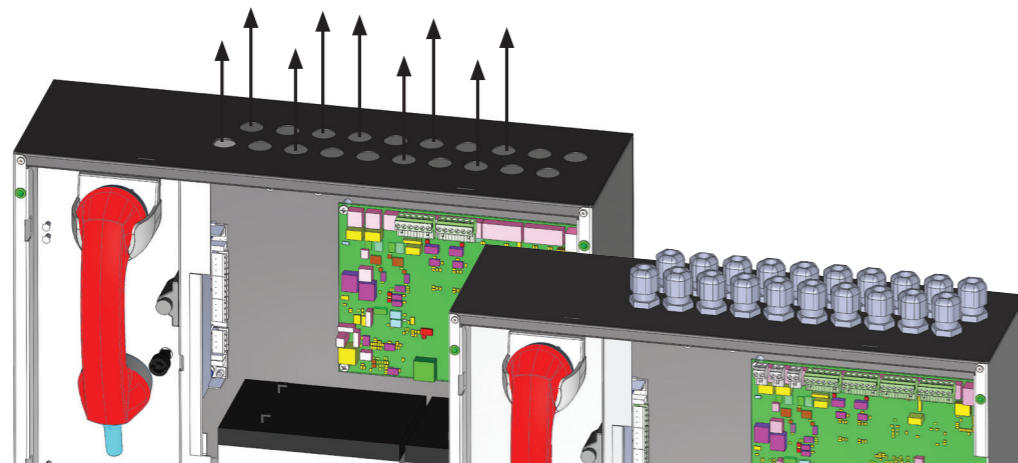

Step 2

Lift user interface

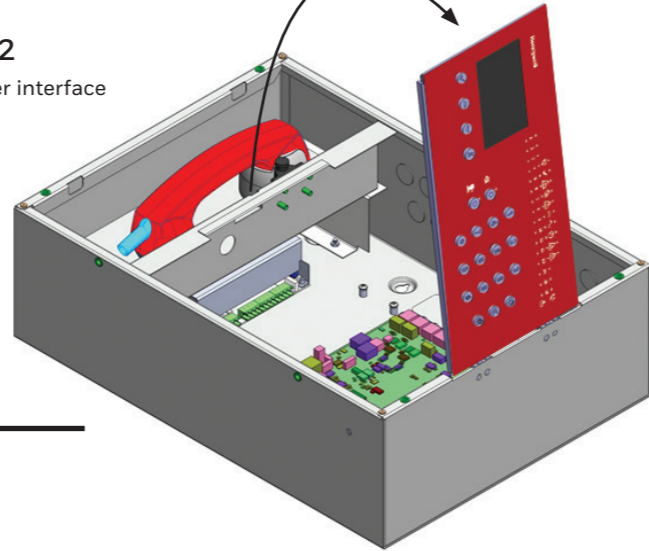

Step 5

Wiring Instructions.

